



**9A Apalie Drive Modbury SA**

2  1  2 

Move in and do nothing.

Villa style home.

- Freshly decorated
- New flooring
- Solar panels
- Auto watering system
- Landscaped garden
- Alfresco dining

**Type** : House  
**Price** : UNDER CONTRACT  
**Land Size** : 327 sqm  
**View** : <https://www.martinrealestate.com.au/sale/sa/north-north-east-suburbs/modbury/residential/house/8168157>



**Colin Martin**  
08 8361 7111

[For full version visit the website](https://www.martinrealestate.com.au)

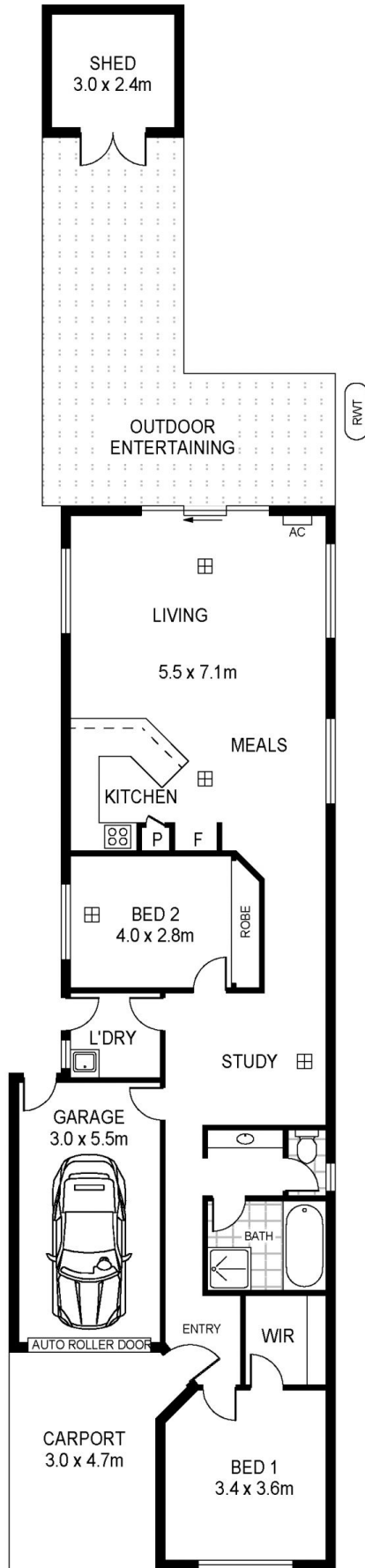

Scale in metres. Indicative only. Dimensions are approximate. All information contained herein is gathered from sources we believe to be reliable. However we cannot guarantee its accuracy and interested persons should rely on their own enquiries

INT : 109m<sup>2</sup>  
 GARAGE : 17m<sup>2</sup>  
 CARPORT : 15m<sup>2</sup>  
 ENTER'NING : 32m<sup>2</sup>

9A Apalie Drive, Modbury